

**VERSACHOCK®**

Innovative Marine Solutions  
[www.versachock.com](http://www.versachock.com)

# Owners Manual Tender Chocks

(REV. 10/25/23)

**Models: VCTENDER/VCTENDERHD  
VCTENDERWHL**





## Table of Contents

1. Cover
2. Table of Contents
3. Features and Specifications
4. Policies
5. Important Notes/Kit Contents
6. Installation Tips
7. Tie Down Information and Installation
8. Installation
9. Dimensions
10. Contact Information

### ***Mission Statement***

***VersaChock is committed to offer our customers the most innovative, high-quality products, while providing the best customer service.***

## Features and Specifications

- 4 White powder coated base brackets
- 4 Removable white powder coated aluminum chock assemblies
- Bunks have semi-rigid vinyl hull protector strips
- Capacity: 1250 lbs/500 lbs maximum horizontal force
- Easy to store when not in use
- Universal design fits most shapes and sizes of tenders and jet skis
- Dimensions (approximate): 9"L x 8"W x 6"H
- Tie downs required (sold separately)
- Twelve ¼" screws required for installation (not included)



**VCTENDER**



**VCTENDERHD**



**VCTENDERWHL**



## Thank you

for purchasing a VersaChock product! We strive at creating and manufacturing the most innovative, highest quality products. VersaChock products are manufactured by Jefferson Design Inc, based in Tampa Bay Florida. We support local suppliers whenever possible and assemble everything here in the Tampa Bay area. We hope our products offer you great enjoyment for many years. We always welcome your comments and feedback! If you have any questions or concerns, please do not hesitate to contact us. Your satisfaction is our number one priority!

## Policies

### Liability

The installation and use of VersaChock products are entirely the customers' risk. We highly recommend an experienced technician evaluate the product specification, usage and installation prior to purchase/installation. We also recommend professional installation. Safety and customer satisfaction are our number one priority!

### Warranty

VersaChock warrants products due manufacturers defects for one year from date of purchase to original retail purchaser. VersaChock will, at its discretion, repair or replace the defective product. Shipping costs, labor for product removal/installation, loss of use, loss of time, consequential loss, or any other claim of loss arising, will not be the responsibility of VersaChock (unless required by law) VersaChock will not be responsible for improper installation/use, abuse, overloading product, extreme conditions, or neglect.

### Returns

Returns will only be accepted with a pre-authorized RA (Return Authorization) Please contact customer service to obtain an RA.

Defective returns: will only be accepted with an RA. Return must include description of defect. Refund will be issued if defect is due to the fault of VersaChock.

### Shipping Damage and Loss

VersaChock inspects 100% of product packed and shipped, so it is not likely product to have damage caused prior to shipping. All damage and loss due to shipping will require claims be made with shipping carrier. Please contact carrier immediately upon damage or loss.

**\*\* VersaChock Customer Service will provide assistance for returns and claims in order to provide the best experience for our customers! Your satisfaction is our number one priority!**

## Important Notes:

- Please seek professional installation if you are not comfortable installing yourself.
- Under no circumstances should person/s or animal be allowed in watercraft whether loading, or in stored position.
- Do not add additional gear, etc. that may subject the watercraft to be over the maximum weight capacity.
- Always pull drain plug when stored to prevent excess water to accumulate, which could cause excess weight.
- Ample Tie downs must be installed in order to secure watercraft.
- Be sure the tensioner eyebolts are secure before each use.
- Rinse with freshwater after each use, as saltwater and other contaminants can cause staining, even though we use the most corrosion resistant materials. A periodic thin coat of corrosion proof spray can also help protect the metal parts.
- Not intended for use in extreme conditions (ie: high forces from water, wind, etc)
- Not following any of the above may result in damage, loss and/or serious injury.

## Get Familiar With Your Kit

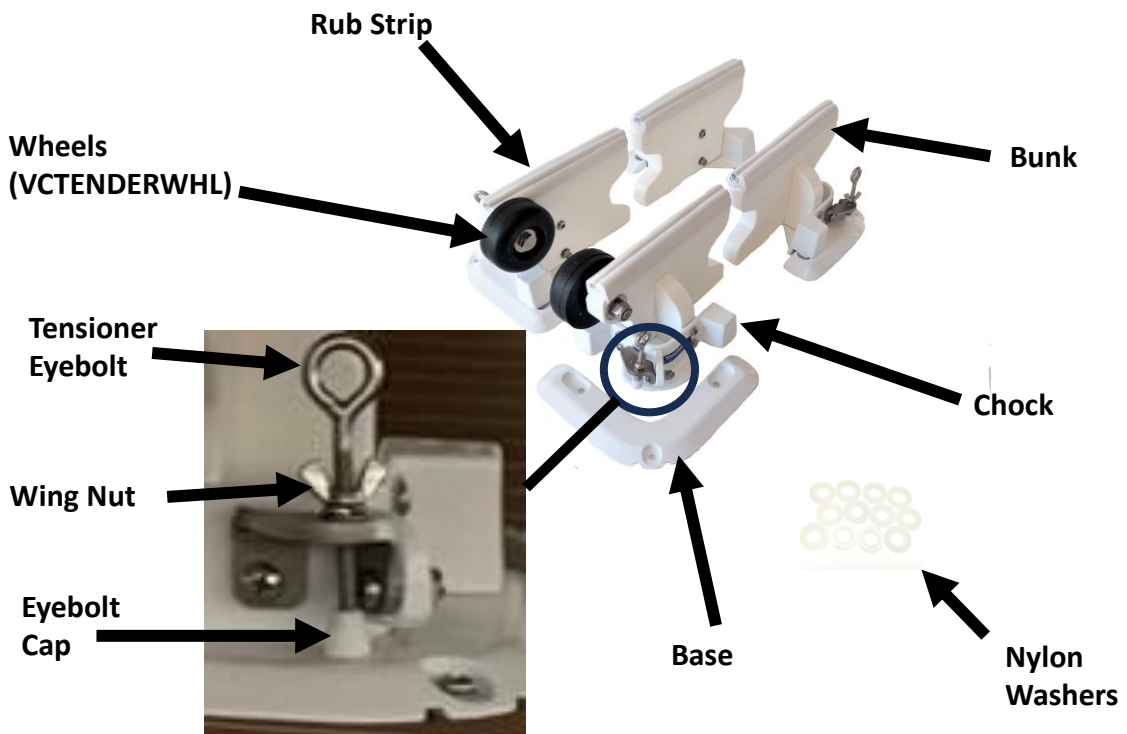

## Installation Tips

- Please seek professional installation help if you are not comfortable installing yourself.
- Avoid locating watercraft where it may be subject to extreme forces (ie: avoid allowing outboard exposure to water running along side of platform, cross waves, back wash, etc.
- Check the integrity of the hull to make sure proper support will be provided.
- Be sure to install adequate tie downs. There are too many variables to specify exact tie down locations for every application, but we have provided some recommendations on the attached diagrams.
- There are too many variables to give specific instructions for every application.
- Please contact a professional installer if you are not comfortable installing this product.

### Size Configuration

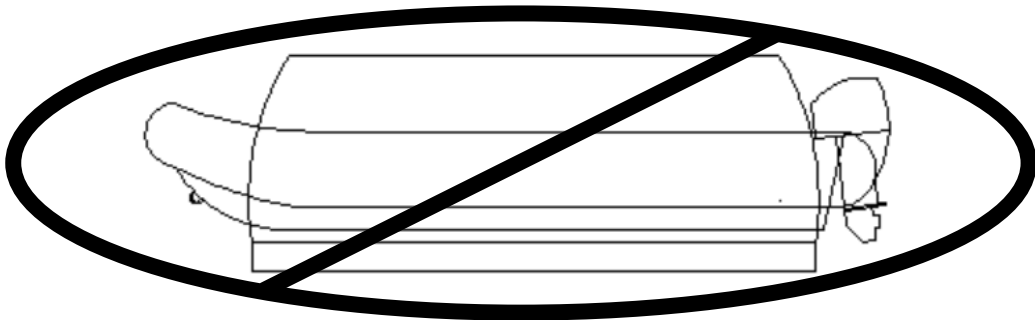

**Not Recommended**



**Recommended**

## Recommended Tie Down Configuration

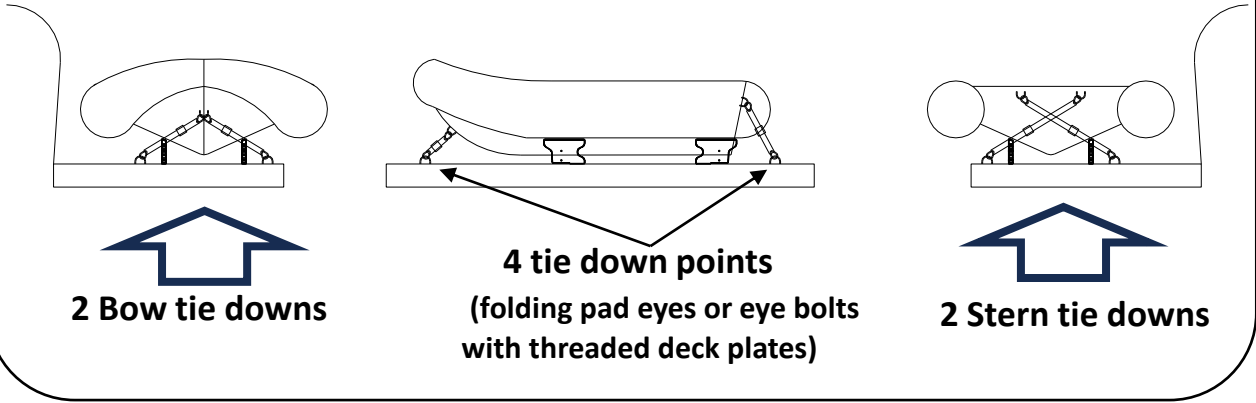

## Basic Steps for Installation

### 1. Determine chock locations.

**Hints:** The wider the chocks are spaced, the more stable support. Keep chock bunks just inboard of chines (if applicable). Never locate chock bunks near the tips of chines (this can cause “point loading” and stress this area). Forward chocks may be spaced closer together so watercraft is angled to drain water. Chocks may be angled for optimal surface contact with hull.

**Method A:** Temporarily place the watercraft on deck/platform onto chocks. Mark base bracket locations with blue tape.

**Method B:** Make a template by moving watercraft over a piece of plastic or cardboard. Trace the watercraft outline onto the plastic. Position chocks on template and trace outline. Transfer template to deck/platform. Mark base bracket locations with blue tape.

**Method C:** Take measurements from watercraft where chocks are to be positioned, then transfer measurements to deck/platform (this is the most difficult method).



**Template Method**



**Chock Positioning**



**Chock Positioning**



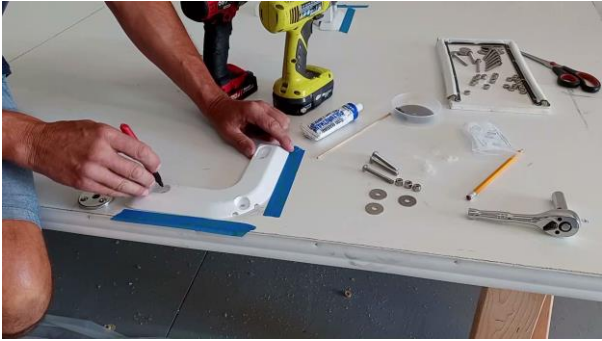

**2. Mark hole locations.**



**5. Tighten screws**



**3. Drill holes.**

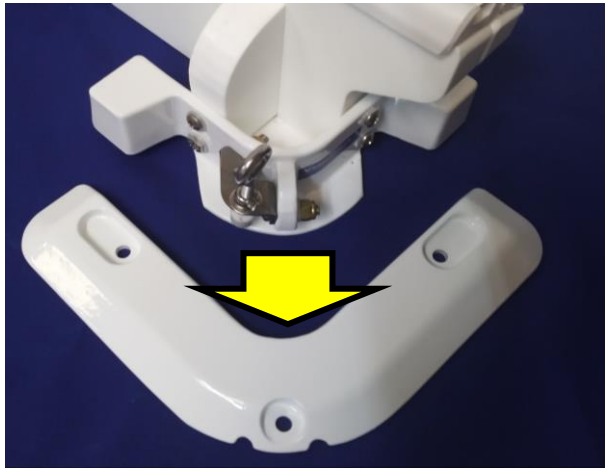

**6. Insert Chock tongue into channel in base bracket (be sure chock is fully engaged)**

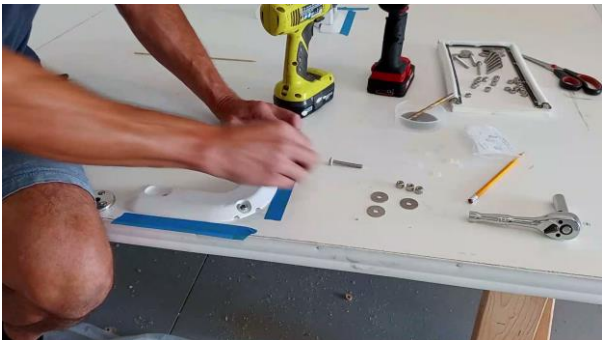

**4. Insert screws (be sure to use nylon washers to protect the base bracket powder coating), followed by washers and nuts.**

**NOTE: Apply sealant, as desired, prior to installing screws.**



**7. Turn tension screw clockwise until chock is snug to base (do not overtighten) Pull on chock to ensure it will not disengage.**

**8. Tighten wing nut to keep tension screw secure.**

**DONE!**



### Dimensional Drawings

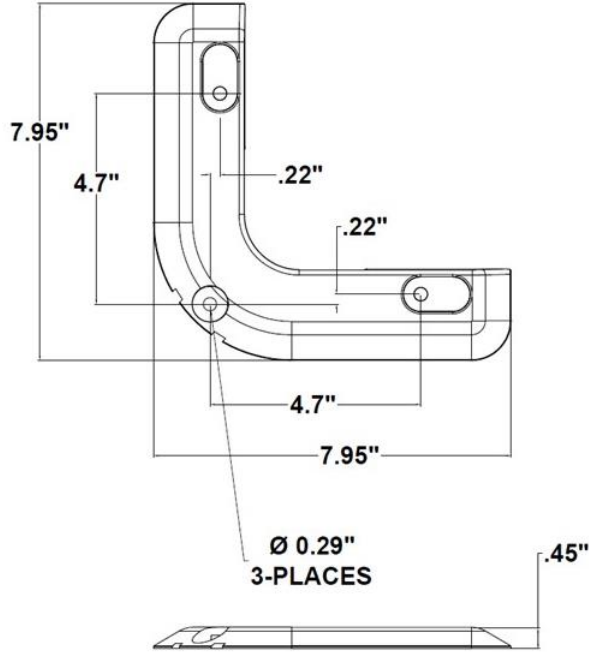

**HD Base Dimensions**

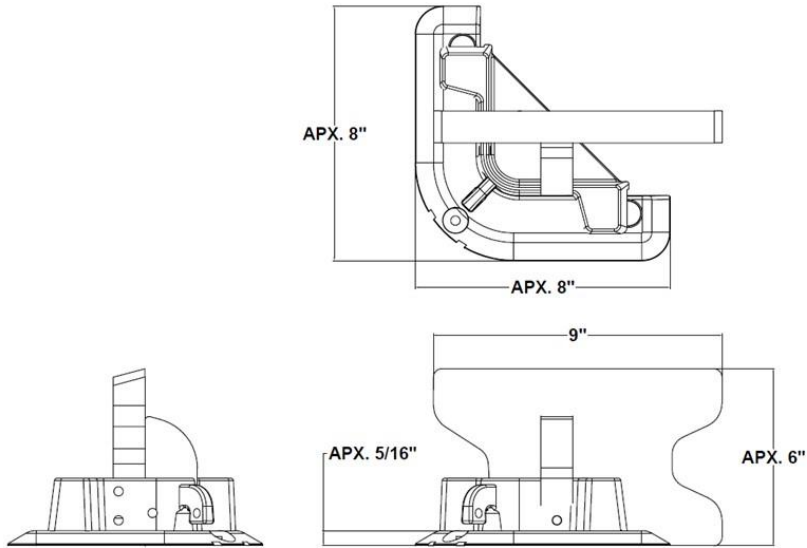

### TENDER CHOCK DIMENSIONS



VersaChock® is part of Jefferson Design Inc  
Jefferson Design Inc, specializes in marine accessories,  
automotive and consumer product design/development  
and manufacturing. With over 35 years of experience,  
Jefferson Design Inc has the expertise to provide our  
customers with the highest quality products with the most  
innovative design.  
All VersaChock® products are proudly made in the USA.

**Jefferson Design Inc**  
**4309 W Pearl Ave, Ste K**  
**Tampa, FL 33611**  
**813-598-8036**  
**Sales@versachock.com**

2023 VersaChock® Copyright. All rights reserved. Mfg by  
Jefferson Design Inc.

Pat.:<https://www.versachock.com/patents/>

\*Note: Because we strive in making continuous  
improvements, some pictures may vary from actual  
products.