

VERSACHOCK®

Innovative Marine Solutions
www.versachock.com

Owners Manual

SeaBob Owners Manual

(REV. 10/26/23)

Model: VCSEABOB



Table of Contents

1. Cover and Table of Contents
2. Policies
3. Features and Specifications, Kit Contents
4. Installation
5. Dimensional Drawings
6. Contact Info



Thank you

for purchasing a VersaChock product! We strive at creating and manufacturing the most innovative, highest quality products. VersaChock products are manufactured by Jefferson Design Inc, based in Tampa Bay Florida. We support local suppliers whenever possible and assemble everything here in the Tampa Bay area. We hope our products offer you great enjoyment for many years. We always welcome your comments and feedback! If you have any questions or concerns, please do not hesitate to contact us. Your satisfaction is our number one priority!

Policies

Liability

The installation and use of VersaChock products are entirely the customers' risk. We highly recommend an experienced technician evaluate the product specification, usage and installation prior to purchase/installation. We also recommend professional installation. Safety and customer satisfaction are our number one priority!

Warranty

VersaChock warrants products due manufacturers defects for one year from date of purchase to original retail purchaser. VersaChock will, at its discretion, repair or replace the defective product. Shipping costs, labor for product removal/installation, loss of use, loss of time, consequential loss, or any other claim of loss arising, will not be the responsibility of VersaChock (unless required by law) VersaChock will not be responsible for improper installation/use, abuse, overloading product, extreme conditions, or neglect.

Returns

Returns will only be accepted with a pre-authorized RA (Return Authorization) Please contact customer service to obtain an RA.

Defective returns: will only be accepted with an RA. Return must include description of defect. Refund will be issued if defect is due to the fault of VersaChock.

Shipping Damage and Loss

VersaChock inspects 100% of product packed and shipped, so it is not likely product to have damage caused prior to shipping. All damage and loss due to shipping will require claims be made with shipping carrier. Please contact carrier immediately upon damage or loss.

**** VersaChock Customer Service will provide assistance for returns and claims in order to provide the best experience for our customers! Your satisfaction is our number one priority!**

Features and Specifications

- 2 HDPE bunks/white powder coated aluminum chock assemblies.
- 2 white powder coated aluminum base brackets.
- Large holes for tie downs and cable lock.
- Tie downs are not included.
- Six ¼" screws required for installation (not included).



Holes for installing tie downs/cable locks

Important Notes:

- Please seek professional installation if you are not comfortable installing yourself.
- Under no circumstances should person/s or animal be allowed in watercraft whether loading, or in stored position.
- Ample Tie downs must be installed in order to secure watercraft.
- Be sure the tensioner eyebolts are secure before each use.
- Rinse with freshwater after each use, as saltwater and other contaminants can cause staining, even though we use the most corrosion resistant materials. A periodic thin coat of corrosion proof spray can also help protect the metal parts.
- Not intended for use in extreme conditions (ie: high forces from water, wind, etc)
- Not following any of the above may result in damage, loss and/or serious injury.

Get Familiar With Your Kit

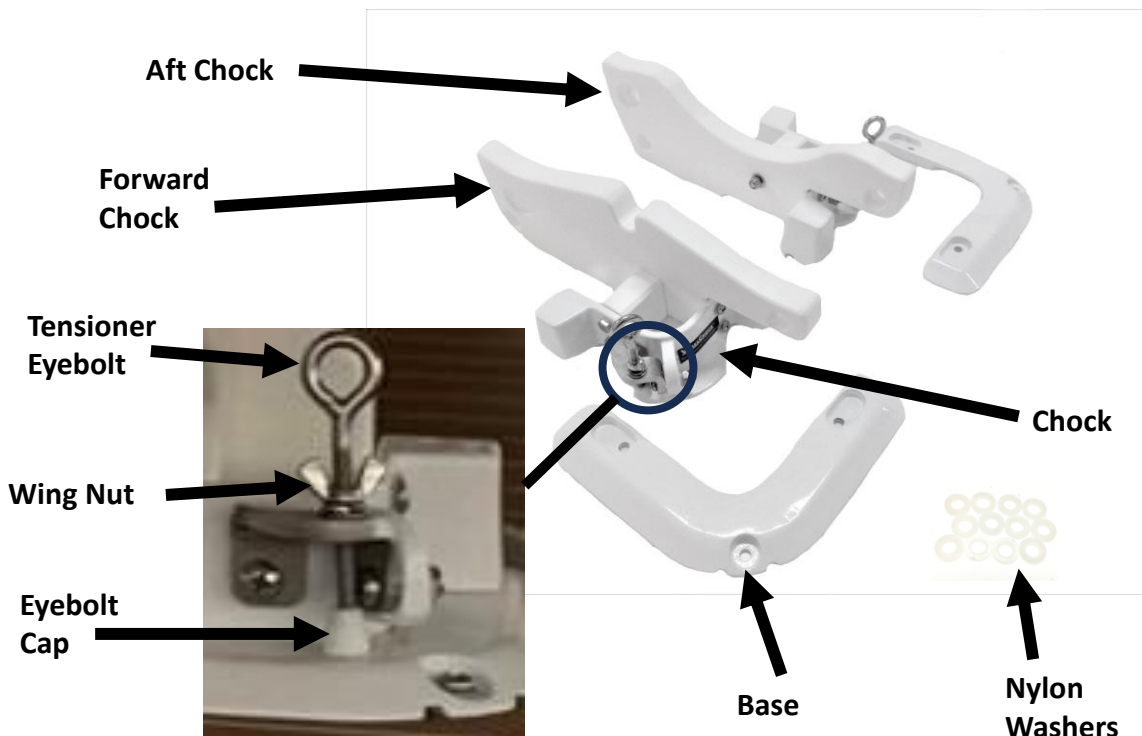

VERSACHOCK®

Innovative Marine Solutions

www.versachock.com

Installation



1. Determine location for storing Seabob and carefully place Seabob on chocks and mark base bracket hole locations.



4. Tighten screws

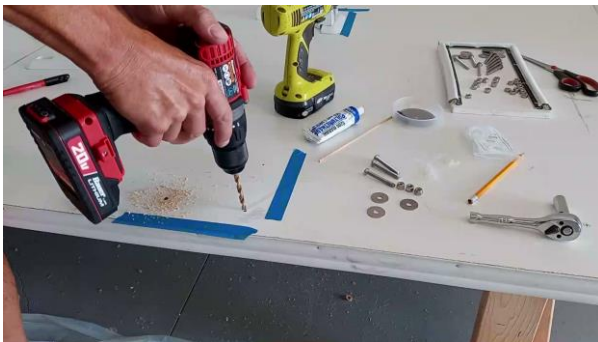

2. Drill holes.

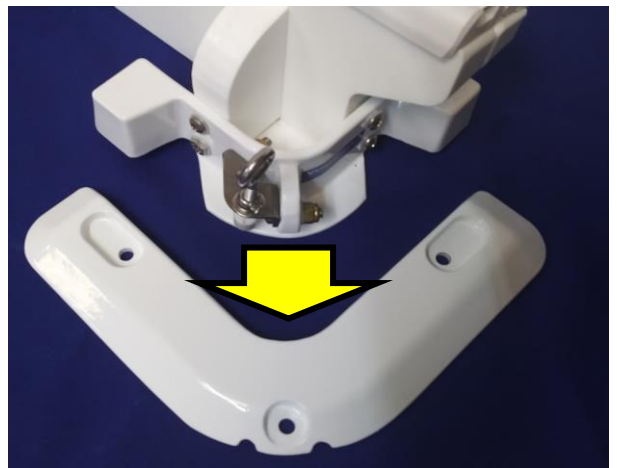

5. Insert Chock tongue into channel in base bracket (be sure chock is fully engaged)

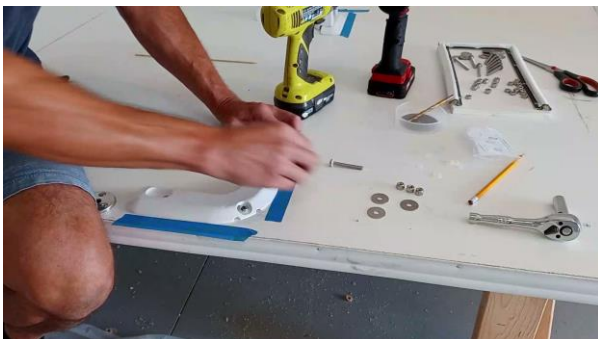

3. Insert screws (be sure to use nylon washers to protect the base bracket powder coating), followed by washers and nuts.

NOTE: Apply sealant, as desired, prior to installing screws.



6. Turn tension screw clockwise until chock is snug to base (do not overtighten) Pull on chock to ensure it will not disengage.

7. Tighten wing nut to keep tension screw secure.

DONE!

Dimensional Drawings

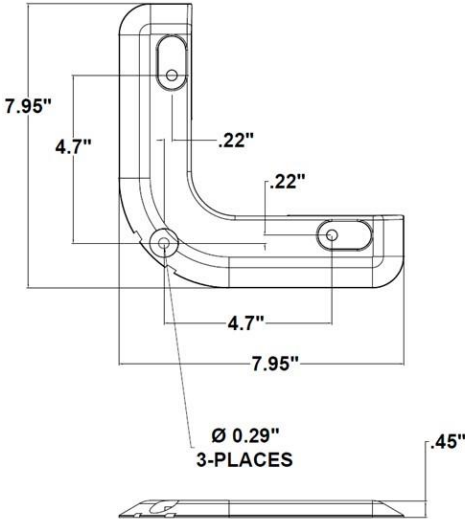
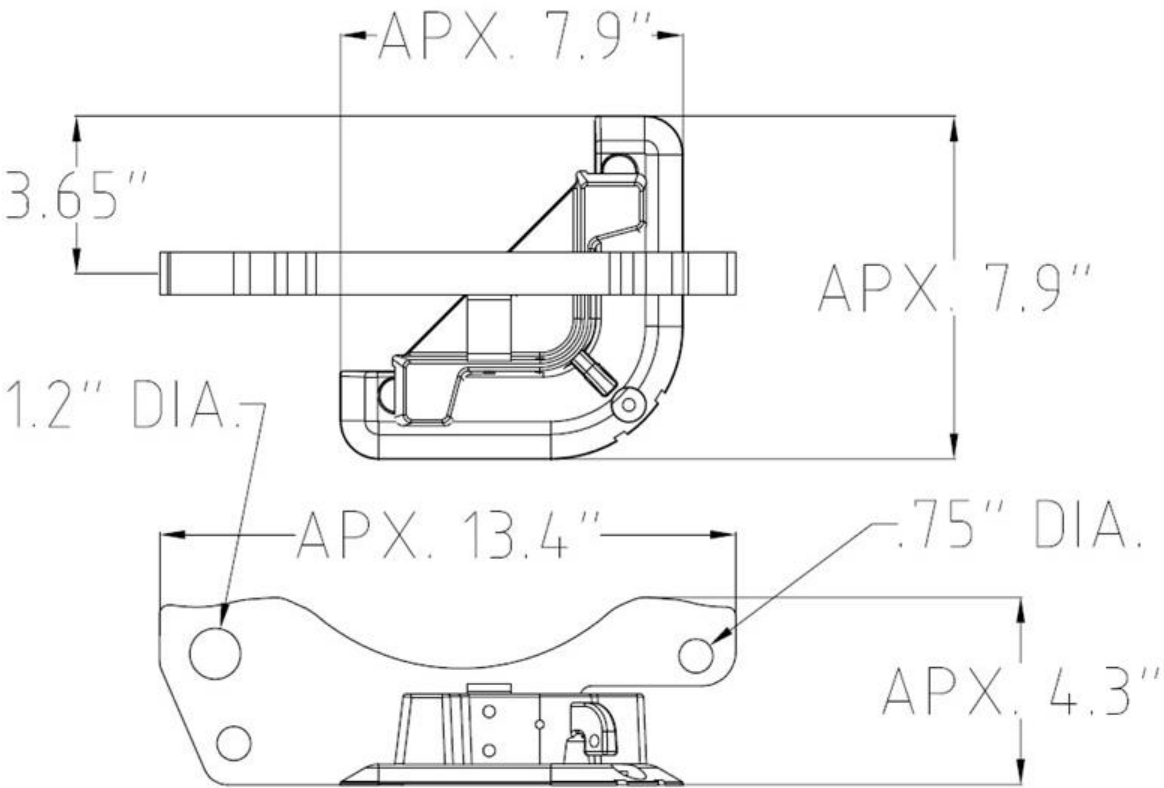

HD Base Dimensions



VersaChock® is part of Jefferson Design Inc. Jefferson Design Inc, specializes in marine accessories, automotive and consumer product design/development and manufacturing. With over 35 years of experience, Jefferson Design Inc has the expertise to provide our customers with the highest quality products with the most innovative design. All VersaChock® products are proudly made in the USA.

**Jefferson Design Inc
4309 W Pearl Ave, Ste K
Tampa, FL 33611
813-598-8036
Sales@versachock.com**

2023 VersaChock® Copyright. All rights reserved. Mfg by
Jefferson Design Inc.

Pat.: <https://www.versachock.com/patents/>

*Note: Because we strive in making continuous improvements, some pictures may vary from actual products.